

Dane aktualne na dzień: 27-04-2026 06:50

Link do produktu: <https://utih.pl/kolo-zebate-z-kolnierzem-16b-2-r2-1-z-10-warynski-p-34507.html>



Koło zębate z kołnierzem 16B-2 R2 1) Z-10 WARYŃSKI

| | |
|--|----------------------|
| Cena | 91,80 zł |
| Numer katalogowy | W-S16B2-10 |
| Kod producenta | W-S16B2-10 |
| Kod EAN | 5902287215687 |
| Waga produktu z opakowaniem jednostkowym | 1.6 |
| Numer katalogowy części | W-S16B2-10 |
| EAN (GTIN) | 5902287215687 |

Opis produktu

Koło zębate hartowane z kołnierzem 16B-2 (R2 1) Z-10
Waryński



Koło łańcuchowe / Sprocket

W-S16B2 1" X 17,02

Do łańcuchów normy: PN77/M-84168, DIN 8187/ISO 606
For chains standard: PN77/M-84168, DIN 8187/ISO 606

DANE TECHNICZNE:

| | |
|--|--------------|
| Promień zęba / Tooth radius: | 26 mm |
| Szerokość zęba / Tooth width: | 15,8 mm |
| Podziałka łańcucha / Pitch: | 1" - 25,4 mm |
| Szerokość wew. łańcucha / Inner width: | 17,02 mm |
| Srednica rolek / Roller diameter: | 15,88 mm |
| Materiał / Material: | C45 |
| Twardość / Hardness: | 47-52 HRC |

* spawana piasta / welded hub

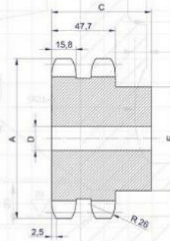

| Indeks | Z | A | B | E | D | C |
|-------------|-----|--------|---------|------|----|----|
| W-S16B2-31 | 31 | 262,0 | 251,08 | *140 | 25 | 70 |
| W-S16B2-32 | 32 | 270,0 | 259,13 | *140 | 25 | 70 |
| W-S16B2-33 | 33 | 278,5 | 267,21 | *140 | 25 | 70 |
| W-S16B2-34 | 34 | 287,0 | 275,28 | *140 | 25 | 70 |
| W-S16B2-35 | 35 | 296,2 | 283,36 | *140 | 25 | 70 |
| W-S16B2-36 | 36 | 304,6 | 291,44 | *140 | 25 | 70 |
| W-S16B2-37 | 37 | 312,6 | 299,51 | *140 | 25 | 70 |
| W-S16B2-38 | 38 | 320,7 | 307,59 | *140 | 25 | 70 |
| W-S16B2-39 | 39 | 328,8 | 315,67 | *140 | 25 | 70 |
| W-S16B2-40 | 40 | 336,9 | 323,75 | *140 | 25 | 70 |
| W-S16B2-41 | 41 | 345,0 | 331,81 | *140 | 25 | 70 |
| W-S16B2-42 | 42 | 353,0 | 339,89 | *140 | 25 | 70 |
| W-S16B2-43 | 43 | 361,1 | 347,97 | *140 | 25 | 70 |
| W-S16B2-44 | 44 | 369,1 | 356,05 | *140 | 25 | 70 |
| W-S16B2-45 | 45 | 377,1 | 364,12 | *140 | 25 | 70 |
| W-S16B2-46 | 46 | 385,2 | 372,20 | *140 | 25 | 70 |
| W-S16B2-47 | 47 | 393,2 | 380,28 | *140 | 25 | 70 |
| W-S16B2-48 | 48 | 401,3 | 388,36 | *140 | 25 | 70 |
| W-S16B2-49 | 49 | 409,3 | 396,44 | *140 | 25 | 70 |
| W-S16B2-50 | 50 | 417,4 | 404,52 | *140 | 25 | 70 |
| W-S16B2-51 | 51 | 425,5 | 412,60 | *150 | 25 | 85 |
| W-S16B2-52 | 52 | 433,6 | 420,68 | *150 | 25 | 85 |
| W-S16B2-53 | 53 | 441,7 | 428,76 | *150 | 25 | 85 |
| W-S16B2-54 | 54 | 449,8 | 436,84 | *150 | 25 | 85 |
| W-S16B2-55 | 55 | 457,9 | 444,92 | *150 | 25 | 85 |
| W-S16B2-56 | 56 | 466,0 | 453,01 | *150 | 25 | 85 |
| W-S16B2-57 | 57 | 474,0 | 461,08 | *150 | 25 | 85 |
| W-S16B2-58 | 58 | 482,1 | 469,16 | *150 | 25 | 85 |
| W-S16B2-59 | 59 | 490,2 | 477,24 | *150 | 25 | 85 |
| W-S16B2-60 | 60 | 498,3 | 485,32 | *150 | 25 | 85 |
| W-S16B2-62 | 62 | 514,5 | 501,49 | *150 | 25 | 85 |
| W-S16B2-64 | 64 | 530,7 | 517,65 | *160 | 25 | 90 |
| W-S16B2-65 | 65 | 538,8 | 525,73 | *160 | 25 | 90 |
| W-S16B2-66 | 66 | 546,8 | 533,80 | *160 | 25 | 90 |
| W-S16B2-68 | 68 | 562,9 | 549,98 | *160 | 25 | 90 |
| W-S16B2-70 | 70 | 579,2 | 566,15 | *160 | 25 | 90 |
| W-S16B2-72 | 72 | 595,4 | 582,31 | *160 | 25 | 90 |
| W-S16B2-75 | 75 | 619,7 | 606,56 | *160 | 25 | 90 |
| W-S16B2-76 | 76 | 627,0 | 614,64 | *160 | 25 | 90 |
| W-S16B2-78 | 78 | 643,3 | 630,81 | *160 | 25 | 90 |
| W-S16B2-80 | 80 | 660,0 | 646,97 | *160 | 25 | 90 |
| W-S16B2-85 | 85 | 699,9 | 687,39 | *160 | 25 | 90 |
| W-S16B2-90 | 90 | 740,3 | 727,80 | *160 | 25 | 90 |
| W-S16B2-95 | 95 | 781,1 | 768,22 | *160 | 25 | 90 |
| W-S16B2-100 | 100 | 821,1 | 808,64 | *160 | 25 | 90 |
| W-S16B2-110 | 110 | 902,0 | 889,48 | *160 | 25 | 90 |
| W-S16B2-114 | 114 | 934,3 | 921,81 | *160 | 25 | 90 |
| W-S16B2-120 | 120 | 982,8 | 970,32 | *160 | 25 | 90 |
| W-S16B2-125 | 125 | 1023,3 | 1010,73 | *160 | 25 | 90 |

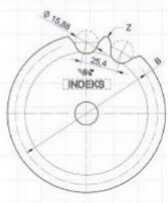

| Indeks | Z | A | B | E | D | C |
|------------|----|-------|--------|------|----|----|
| W-S16B2-8 | 8 | 77,0 | 66,37 | 42 | 16 | 65 |
| W-S16B2-9 | 9 | 85,0 | 74,27 | 50 | 16 | 65 |
| W-S16B2-10 | 10 | 93,0 | 82,19 | 56 | 16 | 65 |
| W-S16B2-11 | 11 | 101,5 | 90,14 | 64 | 20 | 70 |
| W-S16B2-12 | 12 | 109,0 | 98,14 | 72 | 20 | 70 |
| W-S16B2-13 | 13 | 117,0 | 106,12 | 80 | 20 | 70 |
| W-S16B2-14 | 14 | 125,0 | 114,15 | 88 | 20 | 70 |
| W-S16B2-15 | 15 | 133,0 | 122,17 | 96 | 20 | 70 |
| W-S16B2-16 | 16 | 141,0 | 130,20 | 104 | 20 | 70 |
| W-S16B2-17 | 17 | 149,0 | 138,22 | 112 | 20 | 70 |
| W-S16B2-18 | 18 | 157,0 | 146,28 | 120 | 20 | 70 |
| W-S16B2-19 | 19 | 165,2 | 154,33 | 128 | 20 | 70 |
| W-S16B2-20 | 20 | 173,2 | 162,38 | 130 | 20 | 70 |
| W-S16B2-21 | 21 | 181,2 | 170,43 | 130 | 25 | 70 |
| W-S16B2-22 | 22 | 189,3 | 178,48 | *130 | 25 | 70 |
| W-S16B2-23 | 23 | 197,5 | 186,53 | *130 | 25 | 70 |
| W-S16B2-24 | 24 | 205,5 | 194,59 | *130 | 25 | 70 |
| W-S16B2-25 | 25 | 213,5 | 202,66 | *130 | 25 | 70 |
| W-S16B2-26 | 26 | 221,6 | 210,72 | *130 | 25 | 70 |
| W-S16B2-27 | 27 | 229,6 | 218,79 | *130 | 25 | 70 |
| W-S16B2-28 | 28 | 237,7 | 226,85 | *130 | 25 | 70 |
| W-S16B2-29 | 29 | 245,8 | 234,92 | *130 | 25 | 70 |
| W-S16B2-30 | 30 | 254,0 | 243,00 | *130 | 25 | 70 |

* Tabela zawiera pełną gamę produktów, także produktów na specjalne zamówienie. Aktualnie dostępne koła znajdziesz w systemie zamówień, o pozostałe pytaj opiekuna handlowego.

* Tabela zawiera pełną gamę produktów, także produktów na specjalne zamówienie. Aktualnie dostępne koła znajdziesz w systemie zamówień, o pozostałe pytaj opiekuna handlowego.

